



Inflate Your Fun™



DO NOT RETURN TO YOUR RETAILER

QUESTIONS, PROBLEMS, MISSING PARTS WITH THIS PRODUCT?

PLEASE CALL OUR AFTERSALES SERVICE DEPARTMENT 8:30AM TO 5:30PM
MOUNTAIN STANDARD TIME (GMT-7) MONDAY THROUGH FRIDAY

**RECTANGULAR FRAME POOL
OWNER'S MANUAL**

1-855-838-3888

<http://www.bestway-service.com>

E-mail: aftersales@bestway-northamerica.com

Bestway (USA) Inc.

1320 S. Priest Drive, Suite 103

Tempe, Arizona 85281

United States

Tel: 1 855 838 3888

Fax: 1 480 838 1888

E-mail: info@bestway-northamerica.com

Bestway Central & South America Ltda

Salar de Ascotan 1282, Parque Enea,

Pudahuel, Santiago, Chile

Tel: 56 2 365 0315

Fax: 56 2 365 0323

E-mail: info@bestway-southamerica.com

Mexico

Tel: 52 81 8346 3416

Fax: 52 81 8346 6581

E-mail: mexico@bestway-southamerica.com

Bestway Inflatables & Material Corp.

No.3065 Cao An Road, Shanghai, 201812, China.

Tel: 86 21 6913 5588

Fax: 86 21 5913 8383

E-mail: info@bestway-shanghai.com

Thank you for buying a Bestway pool. In order to ensure that you gain maximum enjoyment and safe use of your pool please follow the installation instructions in the DVD enclosed in your retail box along with the important safety guidelines in your owner's manual.

Assembly usually takes approximately 20 minutes with 2-3 people.

(For 287cm x 201cm x 100cm /113" x 79" x 39.5" pool).

Assembly usually takes approximately 30 minutes with 2-3 people.

(For 404cm x 201cm x 100cm /159" x 79" x 39.5" pool).

IMPORTANT SAFETY INSTRUCTIONS

READ AND FOLLOW ALL SAFETY INFORMATION AND INSTRUCTIONS. KEEP FOR FUTURE REFERENCE.

FAILURE TO FOLLOW THESE WARNINGS AND INSTRUCTIONS CAN RESULT IN SERIOUS INJURY OR DEATH TO USERS, ESPECIALLY CHILDREN.

WARNING

WARNING
PREVENT DROWNING

Closely watch children who are in or near this pool!
Children under 5 are at highest risk for drowning!

WARNING
STAY AWAY FROM DRAINS & SUCTION FITTINGS

Your hair, body & jewelry can get sucked into drain!
You could be held under water & drown!

WARNING
NO DIVING

You can break your neck and be paralyzed!

The safety of your children depends entirely on you! Children, especially children younger than five years, are at high risk of drowning.

Drowning occurs silently and quickly and can occur in as little as 2 in. (5cm) of water.

Keep children in your direct sight, stay close, and actively supervise them when they are in or near this pool and when you are filling and emptying this pool.

When searching for a missing child, check the pool first, even if child is thought to be in the house.

Empty pool completely after each use and store the empty pool in such a way that it does not collect water from rain or any other source.

Assign at least one person in charge of safety. Increase supervision if there are several people in the swimming pool. Teach your children to swim if possible.

Test the water temperature before entering the pool by splashing water on your neck, arms and legs.

Prohibit running and playing games near the swimming pool. Pool and accessories should only be assembled by competent adults.

Your pool should be filled by low pressure water flow in order to prevent undue stress to the liner. Bestway will not be responsible for damage to the pool due to filling via water-truck. (See FAQ's)

Do not straddle, sit, lean over or put pressure onto the top rail, doing so could result in collapse of the pool and flooding, causing serious personal injury and/or damage to personal property.

Do not swim alone.

Store chemicals and accessories out of the reach of children.

Never add chemicals to pool while it is occupied. Consult a specialist pool supply retailer to ensure correct chemical usage.

Pool water should be tested regularly to ensure that the PH and chlorine concentration in the water is optimal for safe and enjoyable use throughout the season.

Household pets should be kept clear of pool area to avoid structural damage to pool.

Remove cover completely when in use.

A working electronic detector should be installed to alert you if someone has entered the pool area.

Under no circumstances should this equipment replace an adult's nearby supervision.

The pools shall be set up so that they comply with local safety and building codes.

Only use Bestway accessories with Bestway pools.

Properly maintain your pool in order to increase life span and safe use. (See Pool Maintenance Section)

Always keep the pool clean and clear. The bottom of the pool shall be visible at all times from the outside perimeter of the pool.

Use artificial lighting during nighttime pool use, to illuminate all safety signs, ladders, steps, pool floor and walks.

All equipment should be inspected frequently to detect and avoid deterioration, corrosion, broken parts or other hazards, which may cause injury.

Remember to reapply sunscreen protection regularly and always after swimming.

Drowning Risk:

- Keep unsupervised children from accessing the pool by installing fencing or other approved barrier around all sides of the pool. State or local laws or codes may require fencing or other approved barriers. Check state or local laws and codes before setting up the pool. Refer to the list of barrier recommendations and guidelines as described in CPSC Publication No.362.
- Remove pool ladders before leaving the pool. Children as young as 2 years have climbed up ladders and into pools and drowned.
- Do not leave toys inside pool when finished using, since toys and similar items might attract a child to the pool.
- Position furniture (for example, tables, chairs) away from pool and so that children cannot climb on it to gain access to the pool.
- Locate pumps and filters in such a way that children cannot climb on them and gain access to the pool.
- If a drain or suction outlet cover is missing or broken, do not use the pool. Suction can cause body part entrapment, hair and jewelry entanglement, evisceration, or drowning. Repair or replace the drain or suction outlet cover before allowing the pool to be used.
- After using the pool, remove water to a level of 1/2 in. (1cm) or less.

Diving Risk:

- Do not dive into the pool. Diving into shallow water can result in a broken neck, paralysis, or death.

Electrocution Risk:

- Keep all electrical lines, radios, speakers and other electrical appliances away from the pool.
- Do not place pool near or under overhead electrical lines.
- Do not operate pump while pool is in use.

First Aid:

- Keep a working phone and a list of emergency numbers near the pool.
- Post emergency numbers including:
 - Fire
 - Police
 - Ambulance
 - Poison Control Hotline
 - Full home address
- Become certified in cardiopulmonary resuscitation (CPR). In the event of an emergency, immediate use of CPR can make a life-saving difference.
- Rescue equipment should be located near the pool and the supervising adult should be fully trained to use it.
- Rescue equipment should include but not limited to items such as coastguard approved ring buoy with attached rope and strong, rigid Rescue Pole of at least 366cm (12').
- Learn the necessary rescue operations, especially those relating to rescuing children.

In case of an accident:

- Take all the children out of the water immediately.
- Call for emergency support and follow their instruction/advice.
- Replace wet clothing with dry clothing.

For further safety tips check out the following websites:

www.homesafetycouncil.org

<http://www.safety-council.org/info/child/water.html>

www.safekids.org

www.nspi.org

Safety Barrier Guidelines for Residential Swimming Pool

Section I: Outdoor swimming pool

An outdoor swimming pool, including an inground, aboveground, or onground pool, hot tub, or spa, should be provided with a barrier which complies with the following:

1. The top of the barrier should be at least 48 inches above grade measured on the side of the barrier which faces away from the swimming pool. The maximum vertical clearance between grade and the bottom of the barrier should be 4 inches measured on the side of the barrier which faces away from the swimming pool. Where the top of the pool structure is above grade, such as an aboveground pool, the barrier may be at ground level, such as the pool structure, or mounted on top of the pool structure. Where the barrier is mounted on top of the pool structure, the maximum vertical clearance between the top of the pool structure and the bottom of the barrier should be 4 inches.
2. Openings in the barrier should not allow passage of a 4-inch diameter sphere.
3. Solid barriers, which do not have openings, such as a masonry or stone wall, should not contain indentations or protrusions except for normal construction tolerances and tooled masonry joints.
4. Where the barrier is composed of horizontal and vertical members and the distance between the tops of the horizontal members is less than 45 inches, the horizontal members should be located on the swimming pool side of the fence. Spacing between vertical members should not exceed 1-3/4 inches in width. Where there are decorative cutouts, spacing within the cutouts should not exceed 1-3/4 inches in width.
5. Where the barrier is composed of horizontal and vertical members and the distance between the tops of the horizontal members is 45 inches or more, spacing between vertical members should not exceed 4 inches. Where there are decorative cutouts, spacing within the cutouts should not exceed 1-3/4 inches in width.
6. Maximum mesh size for chain link fences should not exceed 1-3/4 inch square unless the fence is provided with slats fastened at the top or the bottom which reduce the openings to no more than 1-3/4 inches.
7. Where the barrier is composed of diagonal members, such as a lattice fence, the maximum opening formed by the diagonal members should be no more than 1-3/4 inches.
8. Access gates to the pool should comply with Section I, Paragraphs 1 through 7, and should be equipped to accommodate a locking device. Pedestrian access gates should open outward, away from the pool, and should be self-closing and have a self-latching device. Gates other than pedestrian access gates should have a self-latching device. Where the release mechanism of the self-latching device is located less than 54 inches from the bottom of the gate, (a) the release mechanism should be located on the pool side of the gate at least 3 inches below the top of the gate and (b) the gate and barrier should have no opening greater than 1/2 inch within 18 inches of the release mechanism.
9. Where a wall of a dwelling serves as part of the barrier, one of the following should apply:
 - (a) All doors with direct access to the pool through that wall should be equipped with an alarm which produces an audible warning when the door and its screen, if present, are opened. The alarm should sound continuously for a minimum of 30 seconds within 7 seconds after the door is opened. Alarms should meet these requirements of UL2017 General-Purpose Signaling Devices and Systems, Section 77. The alarm should have a minimum sound pressure rating of 85 dBA at 10 feet and the sound of the alarm should be distinctive from other household sounds, such as smoke alarms, telephones, and door bells. The alarm should automatically reset under all conditions. The alarm should be equipped with manual means, such as touchpads or switches, to temporarily deactivate the alarm for a single opening of the door from either direction. Such deactivation should last for no more than 15 seconds. The deactivation touchpads or switches should be located at least 54 inches above the threshold of the door.
 - (b) The pool should be equipped with a power safety cover which complies with ASTM F1346-91 listed below.
 - (c) Other means of protection, such as self-closing doors with self-latching devices, are acceptable so long as the degree of protection afforded is not less than the protection afforded by (a) or (b) described above.
10. Where an aboveground pool structure is used as a barrier or where the barrier is mounted on top of the pool structure, and the means of access is a ladder or steps, then (a) the ladder to the pool or steps should be capable of being secured, locked or removed to prevent access, or (b) the ladder or steps should be surrounded by a barrier which meets Section I, Paragraphs 1 through 9. When the ladder or steps are secured, locked, or removed, any opening created should not allow the passage of a 4-inch diameter sphere.

Section II: Barrier Locations

Barriers should be located so as to prohibit permanent structures, equipment or similar objects from being used to climb the barriers.

SAVE THESE INSTRUCTIONS

Pool Items:

#B56248; #B56251

See below for part descriptions.

Parts:

<p>Stopper plug x 2 #F4H018B-02</p>	<p>Liner</p>	<p>Hose adaptor #F4H019B-03B</p>
<p>Heavy-duty repair patch</p>	<p>Drain valve #F4H019B-01</p>	
<p>2 Pcs</p> <p>Top Rail A</p>	<p>2 Pcs</p> <p>Top Rail B</p>	<p>2 Pcs</p> <p>Top Rail C</p>
		<p>2 Pcs</p> <p>Top Rail D</p>

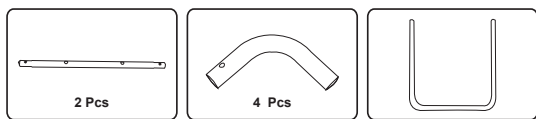

Size of pool	Top Rail Combinations		
	Long Side	Short Side	No. of U-shaped support
404cm x 201cm x 100cm (159' x 79' x 39.5')	B-E-A	C-D	10
287cm x 201cm x 100cm (113' x 79' x 39.5')	B-A	C-D	8

Please see FAQ'S for additional information. Drawings not scaled to size.

Preparation

- Check with your local city council for by-laws relating to fencing, barriers, lighting and safety requirements and ensure you comply with all laws.
- Take the pool and accessories out of the carton with care. If the pool set comes with a ladder, the ladder requires a crosshead screwdriver or an adjustable wrench (not included) to assemble.
- Locate your pool with a minimum of 122cm (48inches) space on all sides so that a child can not use an object to climb into the pool. Do not set up directly under overhead power lines or trees and be sure the location does not contain underground utility pipes, lines or cables of any kind.
- It is essential the pool is set up on solid, level ground. If the pool is set up on uneven ground it can result in collapse of the pool and flooding, Causing serious personal injury and/or damage to personal property. Setting up on uneven ground will void the warranty and service claims.
- Sand should not be used to create a level base, the ground should be dug out if necessary.
- Do not set pool up on driveways, decks, platforms, gravel or asphalt. Ground should be firm enough to withstand the pressure of the water, mud, sand, soft / loose soil or tar are not suitable.
- The ground must be cleared of all objects and debris including stones and twigs.
- NOTE:** Lawn or other vegetation under the pool will die and may cause odors and slime, therefore we recommend removing all grass from where the pool will be located. Avoid locating your pool over or beside areas prone to aggressive plant and weed species as they may grow through the ground cloth or liner.
- If purchased with a pump, the pump should be installed after pool is fully assembled. Remember to locate the intake and return outlets towards the outside power source.
- Pump should be connected to a grounding type receptacle protected by a ground-fault circuit interrupter (GFCI). Do not plug into extension cords, timers or plugzadapters/converters. Locate cord so that it will not be damaged by lawn mowers, hedge trimmers or other cutting equipment.
- If you bought a separate ladder for your pool, make sure it matches the pool size.
- Regularly check to make sure the ladder is properly assembled.
- NOTE:** The ladder is only to be used for entering and exiting the pool.

Installation

Assembly of the Rectangular Frame Pool can be completed without tools.

NOTE: It is important to assemble pool in the order shown below.

- Lay out all parts and check that you have the correct quantities as listed in the parts guide. If you are missing any part do not assemble the pool, contact our Customer Service Department for assistance.
- If pool was purchased with a ground cloth, spread carefully at the desired location. This pool may have been purchased with a Bestway Filter Pump, if a pump is to be used (recommended and also available separately) the pool should be located within distance of a 110-volt AC outlet protected by a GFCI-(Ground Fault Circuit Interrupter).
- Spread out the pool and make sure the pool is right side up, leave for 1 hour to soften the liner in order to make set up easier.
- Turn the pool so the drain valve is near the area where your plan to drain the water and pump valves are facing the GFCI outlet.
ATTENTION: Do not drag the pool on the ground in order to avoid puncturing from sharp objects. Bestway Inflatables will not be responsible for damage caused to the pool due to mishandling or failure to follow these instructions.
- Insert the stopper plug into the inlet and outlet on the wall of the pool from the inside of the pool.
- Assemble the Top Rails. Start with the long side of the pool, begin by sliding Top Rail B into the pool sleeve. Connect Top Rail A or Top Rail E to Top Rail B, ensure the spring-loaded pins snap into the pre-drilled holes. Be sure to reference the Top Rail Combination Chart to determine the correct configuration for your pool. Continue connecting and inserting additional Top Rails. Be sure to line up the holes in the rails with the holes on the sleeves. (See Fig.1)
- Insert the C-Connectors into the Top Rails. (See Fig. 2/1/2.2)
- Install the U-Support: first insert the U-Support through the Pole Support at the bottom of the pool (See Fig. 3.1/3.2), then insert the two ends of the U-Support into the exposed holes on the Top Rail (See Fig. 3.3), ensure the spring-loaded pins snap into position. Repeat this procedure for the remaining U-Supports.
NOTE: Complete one side of the pool before moving to the other side.
- Pull the bottoms of the U-Support outward away from the liner and make the Pole Support taut. Repeat this procedure for remaining U-Supports.
- Ensure drain valve is firmly closed.
- Put 1" to 2" water in the pool to cover the floor. Once pool floor is slightly covered, gently smooth out all wrinkles. Start in the center of the pool and work your way clockwise to the outside. (See Fig. 4)

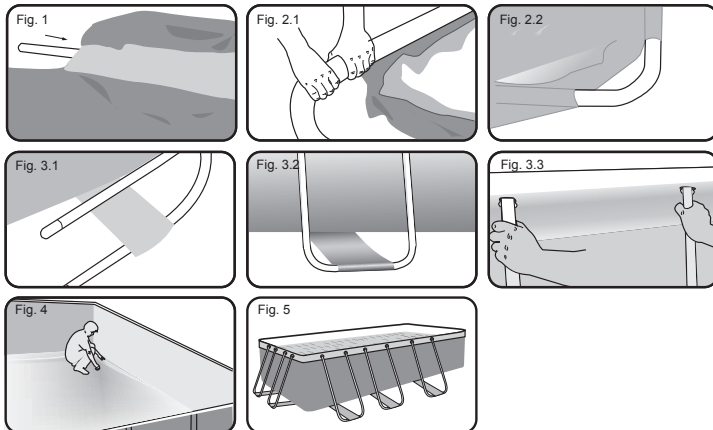

Filling Pool with Water

ATTENTION: Do not leave pool unattended while filling with water.

- Fill pool to drain valve.
STOP
- Turn water off. Check that the water is not collecting on any side to ensure the pool is level. If pool is not level, drain water and re-level ground by digging out. (See Fig. 6) Never attempt to move the pool with water in it, serious personal injury or damage to the pool may result.
NOTE: Your pool may contain up to xxxxx liters / xxxxx gallons which equals xxxxx pounds of pressure. If your pool has any bulge or uneven side then the pool is not level, the sides may burst and the water may discharge suddenly causing serious personal injury and/or damage to property.
- Fill pool to lowest pump valve.
STOP
- Turn water off. Check valves for secure fit.
- Fill pool just below the fill line on the pool's interior. Do not exceed the fill line on the pool's interior. **DO NOT OVERFILL** as this could cause the pool to collapse. In times of heavy rainfall you may need to empty some of the water to ensure the level is correct. (See Fig. 7)
- Check pool for any leaks at valves or seams, check ground cloth for any evident water loss. Do not add chemicals until this has been done.
- In the event of a leak, patch your pool using the patch kit provided. Refer to the FAQ's for further information.
NOTE: Drawings for illustration purpose only. May not reflect actual product. Not to scale.

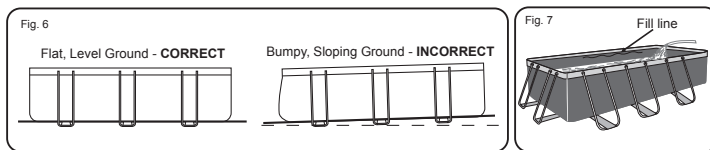

Pool Maintenance

If you do not adhere to the maintenance guidelines below, your health might be at risk, especially that of your children.
NOTE: The filter pump is used to circulate the water and to filter small particles to keep your water free of suspended dirt particles. In order to keep your pool water clean and hygienic you must add chemicals. Refer to filter pump manual to install, operate and maintain the filter pump.

To keep your pool clean:

- Contact your local pool supply shop for advice and purchase of chemicals and PH kits.
- Locate a bucket of water next to pool to clean users' feet before entering pool.
- Cover the pool when not in use.
- Skim pool regularly to avoid settled dirt.
- Change filter cartridge in filter pump every 2 weeks.
- Gently clean any scum from the side with a clean cloth.

Proper maintenance can maximize the life of your pool.

ATTENTION: Ensure you run your filtration system everyday for 7-8 hours, but no more than 8 hours as overheating and damage to your pump may occur. Do not use pump when pool is in use.

Repair

If your pool is damaged, use the repair patch. -see FAQ's for instructions.

Dismantling

- Unscrew the drain valve cap on the outside of the pool counter clockwise and remove.
- Connect the adaptor to the hose and put the other end of the hose in the area where you are going to drain your pool. (Check local regulations for drainage by-laws).
- Screw control ring of the hose adaptor onto the drain valve clockwise. The drain valve will be open and water will start to drain automatically.
ATTENTION: Water flow can be controlled with the control ring.
- When draining is finished, unscrew the control ring to close the valve.
- Disconnect the hose.
- Screw the cap back onto the drain valve.
- Air dry pool.
ATTENTION: Do not leave the drained pool outside.

Storage

- Once pool is completely dry, sprinkle with talcum powder to prevent pool from sticking together, fold pool carefully. If pool is not completely dry, mould may result and will damage the pool liner.
- Store liner and accessories in a dry place with a moderate temperature between 5°C / 41°F and 38°C / 100°F.

Frequently Asked Questions

1. What is a suitable base for the Rectangular Frame pool?

Almost any completely flat, solid, level surface can be used. Do not use sand as a leveling material as it is prone to shifting under the pool. The ground should be dug out until it is perfectly level. Do not set up on driveways, decks, platforms, gravel or asphalt. The ground should be firm enough to withstand the weight and pressure of the water: mud, sand, soft / loose soil or tar are not suitable. A concrete base can be used but care should be taken not to drag the pool across the surface as abrasions could tear the liner. If the pool is to be set up on a lawn, it is recommended that the grass is removed from where the pool will sit as it will die and may cause odors / slime. Certain types of hardy grass can grow through the liner as can aggressive bushes / plants by the side of the pool. Ensure adjacent vegetation is cut back where necessary. Use of a ground cloth assists in protecting the base of the pool.

2. How will I know if my pool is set up on unlevelled ground?

If your pool appears to be bulging on one side it is not set up on level ground. It is important that you empty your pool and move the pool to a level site. If the pool is not on level ground it will place undue stress on the seams and could result in the seams bursting which will cause flooding, property damage and potentially personal injury or death.

Fill your pool following the instructions in the owner's manual carefully. This will ensure that you do not waste water and the pool can be moved easily so that the ground can be leveled at an appropriate time and not after you have completely filled it with water.

3. Can I have my pool filled by a water service?

We recommend using a garden hose under low pressure for filling your pool. If it is necessary to use a water delivery service, it is best to fill the pool with one inch of water by hose and smooth wrinkles first. Use a water service that is able to regulate the flow of water to prevent damage. Ensure you stop at each step as noted in the instruction manual to ensure your pool is level. Bestway will not be held responsible for pools damaged or weakened by water delivery services.

4. What is the maximum fill height of the pool?

Fill pool just below the fill line on the pool's interior. Do not exceed the fill line on the pool's interior. We recommend leaving extra room to account for water displacement when occupants are inside the pool. You may have to top up the water during the season which has been lost through evaporation or normal use.

5. My pool is leaking, what do I do to fix it?

The pool does not need to be emptied to fix any holes. Self-adhesive underwater repair patches can be purchased at your local pool / hardware store. For external use, use the repair patch provided. For internal holes, clean the hole on the inside of the pool to wipe off any oils and algae. Cut a circle large enough to cover the hole and apply the patch securely onto the side in the water. Cut a second patch and apply to the outside of the pool for extra strength. If the hole is in the base of the pool use one patch only and weigh it down with a heavy object while it bonds. If you have patched the pool when it is empty we recommend you leave it at least 12 hours before filling.

6. Where can I buy filter cartridges and how often should I change them?

Filter cartridges to fit your filter pump should be available from the store where you purchased your pool. If not, most mass retailers sell filter cartridges as an accessory. If you are unable to obtain replacements please call our toll-free number and we will assist you in finding a source local to you. The cartridges should be changed every 2 weeks dependent upon use of the pool. Check the filter on a weekly basis and clean by hosing down any debris and particles.
NOTE: Ensure your pump is disconnected from the electrical supply before checking the filter cartridge.

7. How many times a year should I change the water?

This is dependant on the amount of use the pool receives, and the attention paid to covering the pool and keeping chemicals properly balanced. If maintained correctly the water should last a full summer season. Please contact your local pool chemical supplier for detailed information regarding chemicals, they will be able to advise you how to best maintain the cleanliness of your water.

8. Do I need to take my pool down for the winter?

Yes, Above-ground pools may collapse under the weight of ice and snow and the PVC walls will be damaged. We recommend taking the pool down when temperatures fall below 8°C / 45°F. The pool should be stored indoors in a moderate temperature between 5°C / 41°F and 38°C / 100°F. Please store away from chemicals and rodents and out of the reach of children.

9. My pool is fading – why is that?

Excessive use of chemicals can cause the color of the inside of the liner to fade; this is similar to a swimsuit fading over time from repeated contact with chlorinated water.

10. How many years will the pool last?

There is no set time limit for the pool to last; following the instructions in the owner's manual and with proper care, maintenance and storage you can considerably increase the life of your pool. Improper set-up, use or care can result in failure of the pool.

11. The top rails of the pool frame are not rigid because the C-Connectors are loose, will the pool collapse when filled with water?

No, when water is added to the pool the pressure will lock the C-Connectors into position and the top frame will be rigid.

Limited Bestway Warranty

In order for us to help you please have this information to hand before calling:

Sales Receipt

Model: _____

Size: _____

Retailer: _____

Gallons of water (located on side of box) _____

ATTENTION CUSTOMER: Please read this statement carefully and ensure you keep your original store receipt along with this warranty information. Your receipt is required as proof of purchase to ensure your warranty period is calculated correctly.

Your pool has been manufactured using the highest quality materials and workmanship. Bestway stand behind our quality guarantee and assure that your product will be free from manufacturer's defects.

Bestway warranty all components contained in this pool for a period of 90 days from purchase date as noted on your store receipt for the original owner only.

If a manufacturing defect is found within the 90 day warranty period please contact the Customer Service Department who will determine the validity of your claim. Please ensure you have all information to hand as noted on the inside cover of your owner's manual.

If the Customer Service Department requests you to return the product, please ensure it is packed carefully and shipped with insurance to the address requested.

If Bestway determine that a verifiable manufacturing defect is found during the warranty period Bestway will repair or replace the relevant parts at our option provided the relevant proof of purchase is presented.

Bestway does not warranty any items which have been subject to:

- Improper or abnormal use
- Commercial use
- Failure to follow the instructions as provided by Bestway
- Negligence
- Accident
- Vandalism
- Terrorist activity
- Improper use of chemicals
- Exposure to extreme weather conditions
- Negligence during pool set up or disassembly
- Damages beyond Bestway's control and acts of Force Majeure

The warranty will be voided upon any alterations made to the pool or additions of non-Bestway accessories. Bestway can not be held responsible for economic loss due to water or chemical costs nor cost of installation (including water) or any other expenses due to the replacement of defective parts.

For filter pump warranty please see owner's manual provided with the pump.

Bestway (USA) Inc.
1320 S. Priest Drive, Suite 103, Tempe, Arizona 85281 United States
Tel: 1-855-838-3888 Fax: 1-480-838-1888
info@bestway-northamerica.com

Aftersales Service Hours: 8:30AM – 5:30PM Monday through Friday MST (GMT-7)